



## Battery Handling and Precautions

### Soldering

- Do not solder directly onto batteries. Always solder onto solder tag for connection.

### Charging and Discharging

- Always charge batteries before first time application.
- Parallel charging or connection is not recommended. Parallel charging will produce irregular charging currents. Please consult GP Batteries for more details.
- Never short-circuit or reverse polarity in application.
- Do not use different types of batteries in the same battery assembly.
- If the battery has been deep-discharged, a prolonged charging time is required to bring the battery back to full capacity.

### Storage

- Always store batteries in a cool, dry place.
- After long storage, e.g. over a year, it is desirable to cycle (charge/discharge) the battery 3 times to restore full capacity.
- Do not mix batteries with metal objects during storage or transportation to avoid accidental short-circuit.
- Do not store large quantities of batteries in a densely packed condition when they are in a charged or partially charged state.

### Battery Handling

- Do not incinerate or dismantle batteries. Cell components are corrosive and may be harmful to skin and eyes.
- Do not pull on battery lead wires or connector. Excessive force on the leads or connectors can damage the welding joints or other connections.

### Easy Battery Removal

- Some countries have legislation requiring easy removal of batteries from the devices. When designing a product, consideration should be given to the use of a socket connector and an easy-to-open battery compartment.

Distributed by:

# GP Batteries

WORLDWIDE HEADQUARTERS  
HONG KONG

GPI INTERNATIONAL LIMITED

Gold Peak Building, 8/F, 30 Kwai Wing Road,  
Kwai Chung, N.T., Hong Kong  
Tel: (852) 2484 3333 Fax: (852) 2480 5912  
E-mail address: gpil@goldpeak.com  
Website: <http://www.gpbatteries.com.hk>

SALES & MARKETING BRANCH OFFICES

ASEAN  
GP BATTERY MARKETING (SINGAPORE) PTE. LIMITED  
37 Pioneer Road, Singapore 639579  
Tel: (65) 6559 9760 Fax: (65) 6559 9761

MALAYSIA  
GP BATTERY MARKETING (MALAYSIA) SDN. BHD.  
Lot 8, Jalan Pemberita U1/49,  
Temasya Industrial Park,  
40150 Shah Alam, Selangor Darul Ehsan, Malaysia  
Tel: (60) 3 5569 3499 Fax: (60) 3 5569 3498

THAILAND  
GP BATTERY MARKETING (THAILAND) CO., LTD.  
102 Soi Sukhumvit 26, Sukhumvit Road,  
Klongton, Klongtoey,  
Bangkok 10110 Thailand  
Tel: (66) 2 661 3688 Fax: (66) 2 661 3602

TAIWAN  
GOLD PEAK INDUSTRIES (TAIWAN) LIMITED - TAIPEI OFFICE  
Room 1200, International Trade Building, No.205 Sec.1,  
Tun Hua South Road, Taipei 10647, Taiwan R.O.C.  
Tel: (886) 2 2741 4919 Fax: (886) 2 2731 4868/2741 0192

CHINA  
HUIZHOU CHAO BA BATTERY TECHNOLOGY CO., LTD  
2/F, South of Hongye Industrial Building,  
Tianluo Mountain, 14th Industrial District,  
Huizhou City, Guangdong, China  
(Postal Code: 516003)  
Tel: (86) 752 282 8428 Fax: (86) 752 280 2872

HONG KONG  
GP BATTERY MARKETING (H.K.) LIMITED  
Gold Peak Building, 8/F, 30 Kwai Wing Road,  
Kwai Chung, N.T., Hong Kong  
Tel: (852) 2420 0281 Fax: (852) 2494 9349

KOREA  
GP BATTERY MARKETING (KOREA) LIMITED  
Kunsul Hoekwan Building, 9/F, 71-2 Non Hyun-Dong,  
Kang Nam-Gu, Seoul, South Korea  
Tel: (82) 2 549 7188/9, 2 516 3936/7  
Fax: (82) 2 514 0623, 2 516 0621

U.S.A.  
GOLD PEAK INDUSTRIES (NORTH AMERICA) INC.  
11235 West Bernardo Court, San Diego,  
CA 92127-1638, U.S.A.  
Tel: (1) 858 674 6099 Fax: (1) 858 674 6496

CANADA  
GP BATTERY MARKETING INC.  
Unit 7, 7780 Woodbine Avenue, Markham,  
Ontario, Canada L3R 2N7  
Tel: (1) 905 474 9507 Fax: (1) 905 474 9452

LATIN AMERICA  
GP BATTERY MARKETING (LATIN AMERICA) INC.  
8370 NW, 66th Street, Miami, Florida 33166, U.S.A.  
Tel: (1) 305 471 7717 Fax: (1) 305 471 7718

EUROPE  
GP BATTERIES EUROPE B.V.  
Kortijzer 4, 5721 VE Asten,  
The Netherlands  
Tel: (31) 493 681030 Fax: (31) 493 681039

GERMANY  
GP BATTERY MARKETING (GERMANY) GMBH  
Niederlorticker Str. 62, 40667 Meerbusch, Germany  
Tel: (49) 2132 971504/5/6 Fax: (49) 2132 80145

POLAND  
GP BATTERY (POLAND) SP. Z.O.O.  
ul. Slowicza 19, PL-02170 Warsaw, Poland  
Tel: (48) 22 868 0490 Fax: (48) 22 846 7535

U.K.  
GP BATTERIES (U.K.) LIMITED  
Summerfield Avenue, Chelston Business Park,  
Wellington, Somerset, TA21 9JF, U.K.  
Tel: (44) 1 823 660 044 Fax: (44) 1 823 665 595

ITALY  
GP BATTERY MARKETING ITALY S.R.L.  
Via Alessandro Volta 3,  
20094 Assago (MI), Italy  
Tel: (39) 02 488 2512 Fax: (39) 02 488 2865

SCANDINAVIA  
GPBM NORDIC AB  
Grimboasen 5, SE-417 49, Goteborg, Sweden  
Tel: (46) 31 558 600 Fax: (46) 31 556 813

[www.infrarossi.it](http://www.infrarossi.it)

# GP Batteries

## NiCd Rechargeable Batteries



GPPA4RCK-A 06/05 All rights reserved. No parts of this catalogue written or pictorial may be reproduced without the permission of GPI International Ltd.



# Rechargeable Batteries

Committed to continued efforts in R&D and product innovation, supplemented by employment of the latest technology, GP Batteries is one of the most progressive manufacturers to produce various types of batteries to meet different needs.

Nickel Cadmium (NiCd) is the ideal rechargeable battery system to suit applications where battery performance and cost effectiveness are the major concerns. GP Batteries offers a wide range of NiCd batteries which are very durable, reliable, easy-to-use and economical, yet offering good performance. The main categories in active demand are: Standard, High Temperature, High Drain, Economy Series and VC-Series.

## Major Features

- Long service life**  
 Depending on usage conditions, GP NiCd batteries can deliver 300 - 1000 charge / discharge cycles.
- Superior high rate discharge characteristics**  
 Up to 2C high rate discharge is possible.
- Quick charging capability**  
 Rapid charge in about one hour with GP specified charging conditions.
- Excellent overcharge performance**  
 GP NiCd batteries can be continuously overcharged at 0.1C rate for 28 days without leakage or deformation.
- Built-in safety features against misuse**  
 Built-in chemical protection against polarity reversal or overdischarge. A resealable safety vent is incorporated to relieve internal pressure in case of misuse.
- No memory effect**  
 Unlike sintered type rechargeable cells, GP NiCd batteries produced with modern foam electrode technology do not exhibit memory effect.
- High reliability**  
 GP NiCd batteries are manufactured with the best available material using state of the art technology, allowing them to perform with outstanding reliability.

## Major Applications

### Communications

Cellular phones, cordless phones, pager and transceivers.

### Information devices

Notebook computers, personal digital assistants (PDAs), portable facsimile machines.

### Audio and video devices

Digital video cameras, LCD TVs, portable DVD, VCD, MD and CD players.

### Emergency lighting

### Remote controls & security systems

### Other applications

Remote control toys, shavers, massagers, electric tooth brushes, handheld vacuum cleaners, power tools, handheld terminals, electric bicycles, memory back-up etc.

## Cell Construction

### Cylindrical

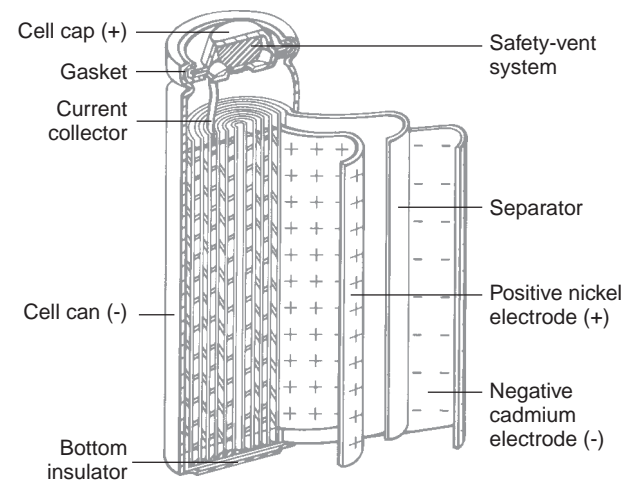

# Specifications

## High Temperature Series

| Cell Size | Model No.         | Nominal Voltage (V) | Capacity (0.2C discharge)*(mAh) |         | Nominal Dimension (mm) |        | Weight (g) | Standard Charge |             | 1 Hr Charge Current (mA)# |
|-----------|-------------------|---------------------|---------------------------------|---------|------------------------|--------|------------|-----------------|-------------|---------------------------|
|           |                   |                     | Minimum                         | Typical | Diameter               | Height |            | Current (mA)    | Time (hour) |                           |
| AA        | AA GP70AAS        | 1.2                 | 700                             | 770     | 14.4                   | 48.2   | 21         | 70              | 16          | Not Applicable            |
| AF        | 2/3 AF GP50AFK    | 1.2                 | 500                             | 550     | 17                     | 28.5   | 15         | 50              | 16          | Not Applicable            |
| Sub-C     | Sub-C GP160SCKT** | 1.2                 | 1600                            | 1760    | 23                     | 43     | 44         | 160             | 16          | Not Applicable            |
|           | Sub-C GP180SCKT   | 1.2                 | 1800                            | 1980    | 23                     | 43     | 46         | 180             | 16          | Not Applicable            |
| C         | C GP250CKT**      | 1.2                 | 2500                            | 2750    | 25.8                   | 50     | 70         | 250             | 16          | Not Applicable            |
| D         | 1/2 D GP250DKT    | 1.2                 | 2500                            | 2750    | 33                     | 37     | 82         | 250             | 16          | Not Applicable            |
|           | D GP450DKT**      | 1.2                 | 4500                            | 4950    | 33                     | 60.5   | 120        | 450             | 16          | Not Applicable            |
|           | D GP450DKTSH      | 1.2                 | 4500                            | 4950    | 33                     | 58     | 120        | 450             | 16          | Not Applicable            |

Typical Ambient Temperature : Charge: 0°C to 70°C, Discharge: -20°C to 70°C, Storage: -20°C to 35°C

## High Drain Series

|       |       |            |     |      |      |    |    |     |     |    |      |
|-------|-------|------------|-----|------|------|----|----|-----|-----|----|------|
| Sub-C | Sub-C | GP200SCK** | 1.2 | 2000 | 2200 | 23 | 43 | 53  | 200 | 16 | 2000 |
| D     | D     | GP450DK    | 1.2 | 4500 | 4950 | 33 | 60 | 130 | 450 | 16 | 4500 |
|       | D     | GP500DK    | 1.2 | 5000 | 5250 | 33 | 60 | 127 | 500 | 16 | 5000 |

Typical Ambient Temperature : Standard Charge : 0°C to 40°C, Fast Charge : 10°C to 40°C, Discharge : -20°C to 50°C, Storage : -20°C to 35°C

## Standard Series

|       |        |            |     |      |      |      |      |      |     |    |      |
|-------|--------|------------|-----|------|------|------|------|------|-----|----|------|
| AAA   | AAA    | GP30AAAK   | 1.2 | 300  | 320  | 10.5 | 43.7 | 10.5 | 30  | 16 | 300  |
|       | AAA    | GP35AAAK   | 1.2 | 350  | 370  | 10.5 | 43.7 | 12   | 35  | 16 | 350  |
| AA    | 1/3 AA | GP18AAK    | 1.2 | 180  | 200  | 14.5 | 16.6 | 8    | 18  | 16 | 180  |
|       | 2/3 AA | GP30AAK    | 1.2 | 300  | 320  | 14.5 | 28.7 | 11   | 30  | 16 | 300  |
|       | 2/3 AA | GP40AAK    | 1.2 | 400  | 450  | 14.5 | 28.7 | 12   | 40  | 16 | 400  |
|       | 2/3 AA | GP50AAK    | 1.2 | 500  | 520  | 14.5 | 28.7 | 13   | 50  | 16 | 500  |
|       | 4/5 AA | GP72AAS    | 1.2 | 720  | 760  | 14.4 | 42.5 | 19   | 72  | 16 | 720  |
|       | AA     | GP60AAS**  | 1.2 | 600  | 660  | 14.4 | 48.2 | 18   | 60  | 16 | 600  |
|       | AA     | GP70AAS**  | 1.2 | 700  | 770  | 14.4 | 48.2 | 18.5 | 70  | 16 | 700  |
|       | AA     | GP80AAS**  | 1.2 | 800  | 850  | 14.4 | 48.2 | 21   | 80  | 16 | 800  |
|       | AA     | GP100AAS** | 1.2 | 1000 | 1030 | 14.4 | 48.2 | 26.5 | 100 | 16 | 1000 |
|       | AA     | GP120AAK   | 1.2 | 1200 | 1300 | 14.5 | 65   | 31   | 120 | 16 | 1200 |
| AF    | 1/3 AF | GP25AFK    | 1.2 | 250  | 275  | 17   | 16.3 | 10   | 25  | 16 | 250  |
|       | 2/3 AF | GP55AFK    | 1.2 | 550  | 605  | 17   | 28.5 | 13.9 | 55  | 16 | 550  |
|       | 2/3 AF | GP70AFK    | 1.2 | 700  | 770  | 17   | 28.5 | 16   | 70  | 16 | 700  |
|       | 4/5 AF | GP120AFK   | 1.2 | 1200 | 1320 | 17   | 43   | 26.5 | 120 | 16 | 1200 |
|       | AF     | GP140AFK** | 1.2 | 1400 | 1400 | 17   | 50   | 32.5 | 140 | 16 | 1400 |
| Sub-C | Sub-C  | GP200AFK   | 1.2 | 2000 | 2200 | 17.5 | 67.5 | 46.3 | 200 | 16 | 2000 |
|       | Sub-C  | GP130SCK   | 1.2 | 1300 | 1430 | 23   | 43   | 44.5 | 130 | 16 | 1300 |
| Sub-C | Sub-C  | GP160SCK** | 1.2 | 1600 | 1760 | 23   | 43   | 47   | 160 | 16 | 1600 |

Typical Ambient Temperature : Standard Charge : 0°C to 40/45°C, Fast Charge : 10°C to 40/45°C, Discharge : -20°C to 50°C, Storage : -20°C to 35°C

## VC Series

|       |       |           |     |      |      |    |    |    |     |    |      |
|-------|-------|-----------|-----|------|------|----|----|----|-----|----|------|
| Sub-C | Sub-C | GP160SCKV | 1.2 | 1600 | 1760 | 23 | 43 | 46 | 160 | 16 | 1600 |
|-------|-------|-----------|-----|------|------|----|----|----|-----|----|------|

Typical Ambient Temperature : Standard Charge : 0°C to 40°C, Fast Charge : 10°C to 40°C, Discharge : -20°C to 50°C, Storage : -20°C to 35°C

# One hour rate with charge termination control. \* After charging at 0.1C for 16 hours. \*\* With UL approval.

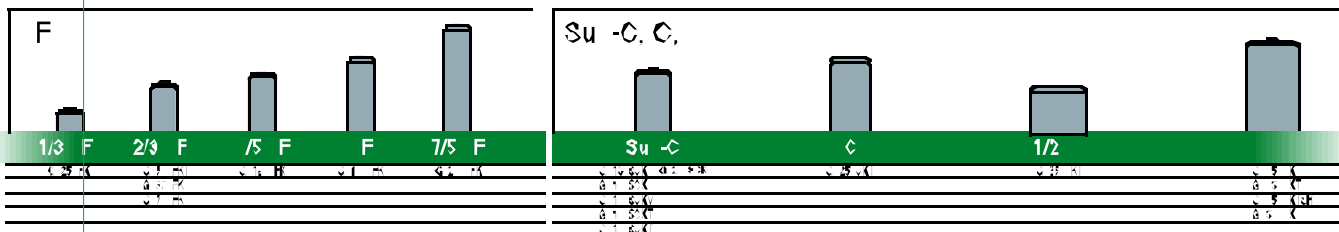
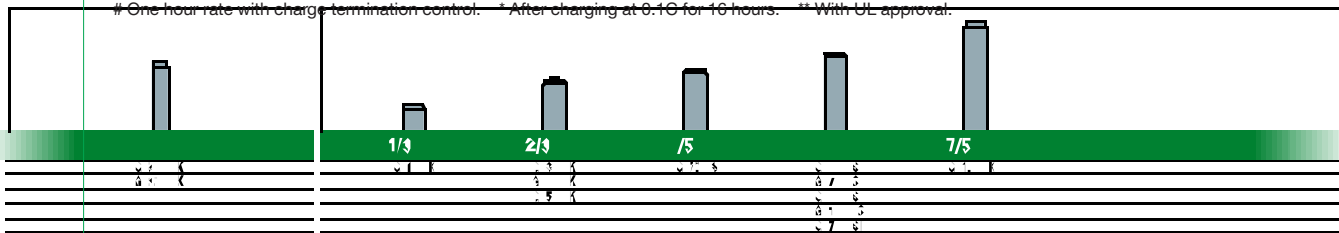

# Configurations

## Designation System for Battery Packs

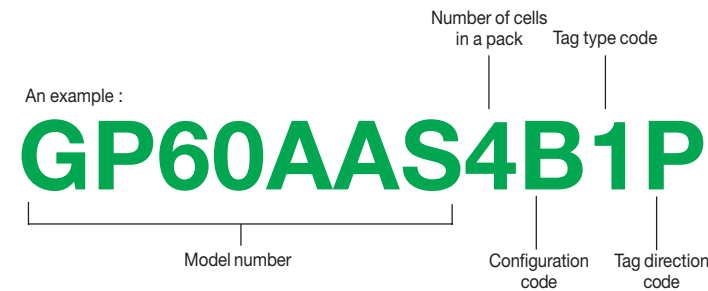

For battery packs with connectors, the last two characters will be used to specify connector type eg. GP60AAS4BMU.

## Standard Configurations for Battery Packs

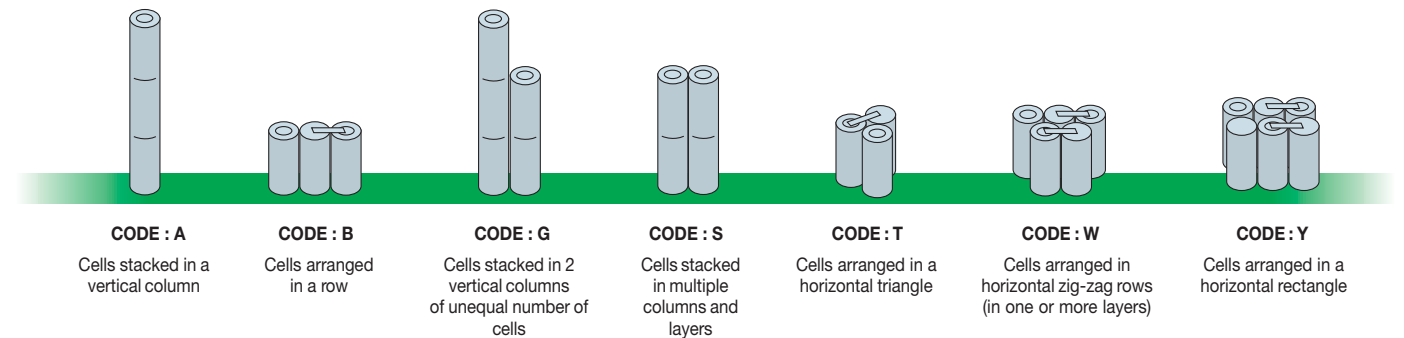

## Tag Type Specifications

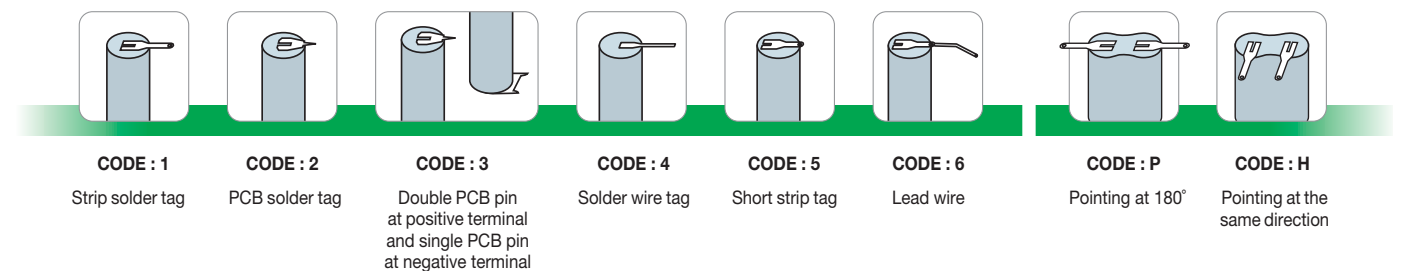

## Tag Direction Codes

## Connector Type Specifications

GP Universal Plug - exclusively from GP, offers distinctive features unparalleled in the market. - U.S. patent no. 5,161,990.

### Major Benefits

- Compatible with most cordless phone models (interchangeable with Mitsumi, JST, Molex plugs etc.)
- Minimise inventory items
- User friendly

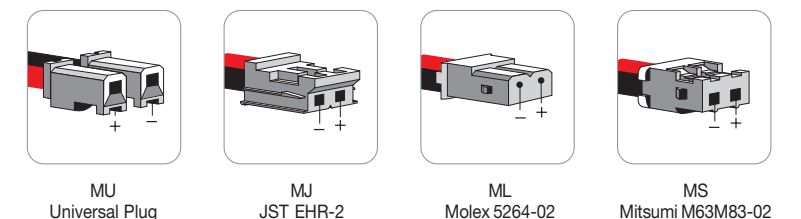

# NiCd Rechargeable Batteries

## Performance Characteristics

### Cylindrical Cells

